

Wheel Features

Tread Material:	TPR	Core Material:	High Strength PP
Bearing:	Single Ball Bearing	Tread Hardness:	75A±3
Temperature:	-15°C~60°C	Running Speed:	3.2km/h

Note: Use beyond temperature range or beyond the recommended speed may shorten product life or even damage the product.







- ✓ Advanced thermo-plastic rubber, silent running, elastic to protect floor
- ✓ Environmental protection, quiet, effectively protect the floor
- ✓ With plastic covers, thread-proof design



Rolling resistance	■ ■ ■ □ □	Good
Wear resistance	■ ■ ■ □ □	Good
Operating noise	■ ■ ■ ■ ■	Excellent
Floor surface preservation	■ ■ ■ ■ ■	Excellent

Bracket Features

- ✓ Easy to operate, convenient to release the brake
- ✓ 304 Stainless Steel material pressed, anti-rust and anti-corrosion
- ✓ Dustproof ring effectively protects grease for long service life
- ✓ Polishing treatment, excellent appearance
- ✓ Precision 304 stainless steel bearing, rust-proof, flexible rotation
- ✓ Galvanized, salt spray test over 48 hours

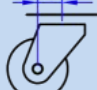
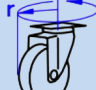
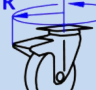
Parameter (mm)							
Wheel Size	Capacity	Wheel Dia.	Wheel Width	Total Height	Offset	Swivel Radius	Swivel Radius
3"	80 kg	75	32	108	34	71.5	108.5
4"	90 kg	100	32	135	32	82	108.5
5"	95 kg	125	32	160	32	94.5	112.5

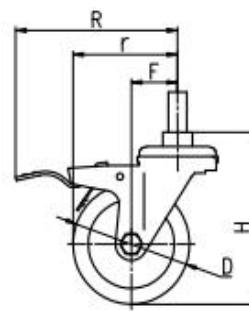
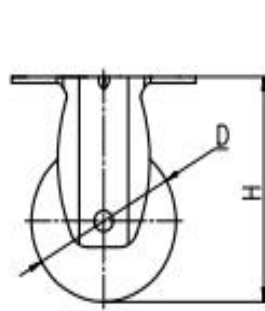
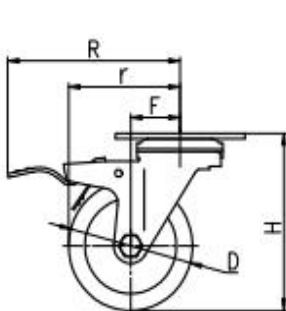

Mounting Drawing

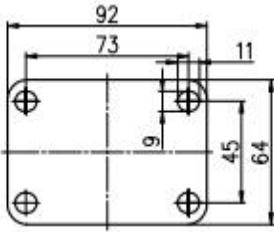

Plate Swivel/Brake

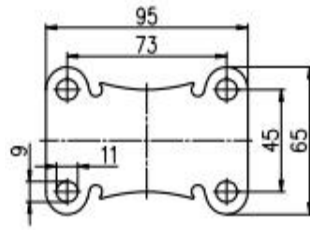
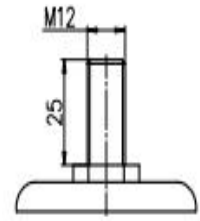

Plate Fixed



Threaded Stem

Product ID					
Wheel Size	Plate swivel	Plate fixed	Plate swivel brake	Threaded stem	Threaded stem brake
3"	20D01-1375	20D03-1375	20D02-1375	20D13-1375	20D14-1375
4"	20D07-1377	20D09-1377	20D08-1377	20D15-1377	20D16-1377
5"	20D10-1378	20D12-1378	20D11-1378	20D17-1378	20D18-1378

Product Details



Electrolytic polishing looks beautiful and simple.

Concave-convex designed dust cover can effectively protect dust and anti-winding.

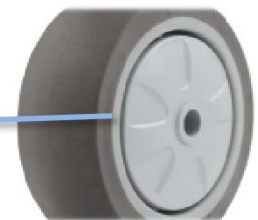

Dust ring can effectively dust and protect grease.

