

Wheel Features

Tread Material:	PU	Core Material:	Cast Aluminum
Bearing:	Ball Bearing	Tread Hardness:	95A±3
Temperature:	-25°C~60°C	Running Speed:	4km/h

Note: Use beyond temperature range or beyond the recommended speed may shorten product life or even damage the product.



- ✔ 2 precision ball bearings,flexible rotation
- ✔ Cast polyurethane on aluminium core,oil resistant,wear resistant,high load capacity
- ✔ Environmental protection,quiet,effectively protect the floor
- ✔ With metal covers,thread-proof design
- ⚠ Not water-proof,humid environment may accelerate aging of the wheel



Rolling resistance	■ ■ ■ ■ □	Very good
Wear resistance	■ ■ ■ ■ ■	Excellent
Operating noise	■ ■ ■ ■ □	Very good
Floor surface preservation	■ ■ ■ ■ □	Very good

Bracket Features

- ✔ ON/OFF pedals,stable braking effect,easy to operate
- ✔ Bracket made of pressed steel plate,firm and strong
- ✔ Thickened top plate,resistant to compress which is hard to deform
- ✔ Reinforced riveted,close gap,high structural strength
- ✔ Dustproof ring effectively protects grease for long sevice life
- ✔ Blue galvanized,ROHS/REACH passed,salt spray test over 72 hours

Parameter (mm)							
Wheel Size	Capacity	Wheel Dia.	Wheel Width	Total Height	Offset	Swivel Radius	Swivel Radius
3"	150 kg	75	32	108	34	71.5	116.5
4"	180 kg	100	32	135	32	82	116
5"	230 kg	125	32	160	32	94.5	121

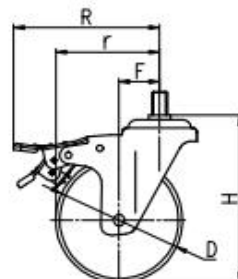
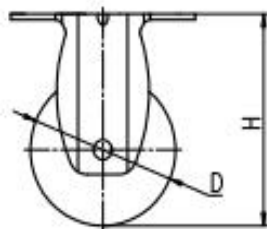
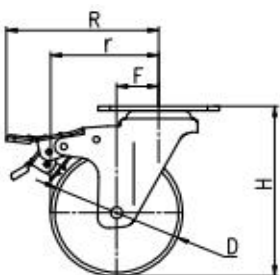

Mounting Drawing

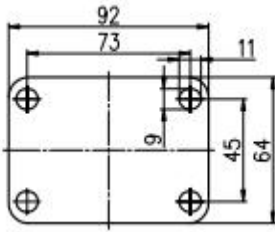

Plate Swivel

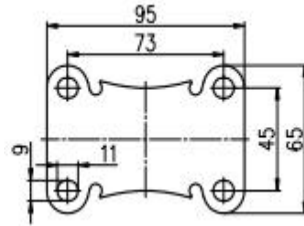
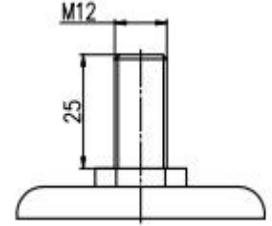

Plate Fixed



Threaded Stem

Product ID					
Product Images					
Wheel Size	Plate swivel	Plate fixed	Plate swivel brake	Threaded stem	Threaded stem brake
3"	20A01-1415	20AB1-1415	20A3B-1415	20A04-1415	20A7B-1415
4"	20A19-1416	20AB3-1416	20A5B-1416	20A22-1416	20A9B-1416
5"	20A28-1417	20AB4-1417	20A6B-1417	20A31-1417	20A1B-1417

Product Details



ON/OFF brake is easy to operate.

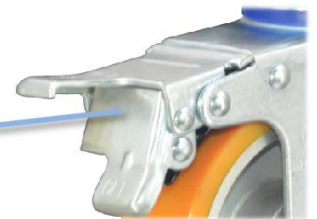

The gap of fancy riveting is close and the structure is stable. Dust ring can effectively dust and protect grease lubrication.

The surface of the bracket is treated with blue and white zinc, which can meet the salt spray test for 72 hours.



Aluminum core hub beautiful and lightweight. Precision double ball bearing is portable and flexible.

