

Wheel Features

Tread Material:	TPR	Core Material:	High Strength PP
Bearing:	Single Ball Bearing	Tread Hardness:	85A±3
Temperature:	-15°C~60°C	Running Speed:	3.2km/h

Note: Use beyond temperature range or beyond the recommended speed may shorten product life or even damage the product.







- ✔ Precision ball bearing, flexible rotation
- ✔ Advanced thermo-plastic rubber, silent running, elastic to protect floor
- ✔ Soft wheel surface is mute, effectively protect the ground
- ✔ The dustproof cover of concave-convex design is beautiful and concise



Rolling resistance	■ ■ ■ □ □	Good
Wear resistance	■ ■ ■ □ □	Good
Operating noise	■ ■ ■ ■ ■	Excellent
Floor surface preservation	■ ■ ■ ■ ■	Excellent

Bracket Features

- ✔ Easy to operate, convenient to release the brake
- ✔ Chrome plating, bright and beautiful
- ✔ Brake fatigue can reach more than 3000 times
- ⚠ Wheel brake only, without direction lock function

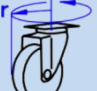
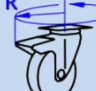
Parameter (mm)							
Wheel Size	Capacity	Wheel Dia.	Wheel Width	Total Height	Offset	Swivel Radius	Swivel Radius
1"	10 kg	25	13	37.5	15.5	28	47.5
1.25"	15 kg	32	13	44.5	15	31	49
1.5"	20 kg	38	17	52	18.5	37.5	59.5
2"	25 kg	50	17	64	19	44	62.5

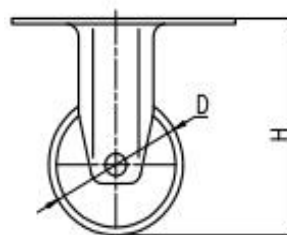
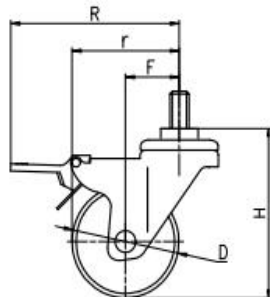
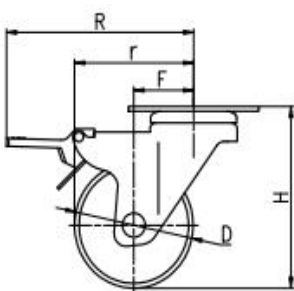

Mounting Drawing

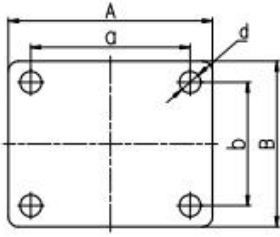

Plate Swivel

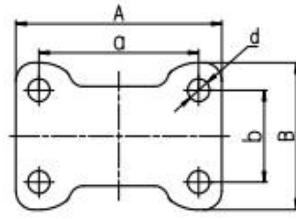
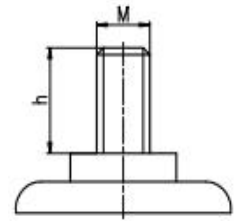

Plate Fixed



Threaded Stem

Wheel Size (inch)	Wheel Dia. (mm)	Plate Size (mm)	Hole Spacing (mm)	Hole Size (mm)	Wheel Size (inch)	Wheel Dia. (mm)	Plate Size (mm)	Hole Spacing (mm)	Hole Size (mm)	Wheel Size (inch)	Wheel Dia. (mm)	Threaded Stem (mm)
1"	25	39×33	30×24	4.3	1"	25	38×30	30×24	4.3	1"	25	M8×20
1.25"	32	39×33	30×24	4.3	1.25"	32	39×33	30×24	4.3	1.25"	32	M8×20
1.5"	38	46×39.5	36×28	4.3	1.5"	38	46×37.5	36×28	4.3	1.5"	38	M8×20
2"	50	46×39.5	36×28	5.2	2"	50	46×38	36×28	5.2	2"	50	M10×25

Product ID

Product Images



Wheel Size

Plate swivel

Plate fixed

Plate swivel
brake

Threaded
stem

Threaded
stem brake

1"

10B01-1510

10B02-1510

10B03-1510

10B04-1510

10B05-1510

1.25"

10B06-1511

10B07-1511

10B08-1511

10B09-1511

10B10-1511

1.5"

10B11-1512

10B12-1512

10B13-1512

10B14-1512

10B15-1512

2"

10B16-1513

10B17-1513

10B18-1513

10B19-1513

10B20-1513

Product Details



The dustproof cover of concave-convex design, beautiful and simple.

Chrome surface treatment, bright and beautiful.

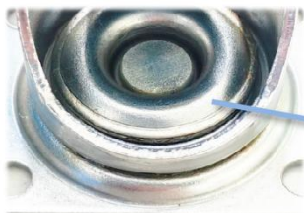

Double steel bowl design, stable structure, flexible rotation.

[English]

